

**gasket dimensions for raised face flanges (RF) as per DIN 2690**

DN	d1 [mm]	PN					
		1 and 2.5	6	10	16	25	40
		d2 [mm]					
4	6					30	
6	10	28	28	38	38	38	38
8	14	33	33	43	43	43	43
10	18	38	38	45	45	45	45
15	22	43	43	50	50	50	50
20	28	53	53	60	60	60	60
25	35	63	63	70	70	70	70
32	43	75	75	82	82	82	82
40	49	85	85	92	92	92	92
50	61	95	95	107	107	107	107
65	77	115	115	127	127	127	127
80	90	132	132	142	142	142	142
100	115	152	152	162	162	168	168
125	141	182	182	192	192	195	195
150	169	207	207	218	218	225	225
175	195	237	237	248	248	255	267
200	220	262	262	273	273	285	292
250	274	318	318	328	330	342	353
300	325	373	373	378	385	402	418
350	368	423	423	438	445	458	475
400	420	473	473	490	497	515	547
450	470	528	528	540	557	565	572
500	520	578	578	595	618	625	628
600	620	680	680	695	735	730	745
700	720	785	785	810	805	830	850
800	820	890	890	915	910	940	970
900	920	990	990	1015	1010	1040	1080
1000	1020	1090	1090	1120	1125	1150	1190
1200	1220	1290	1305	1340	1340	1360	1395
1400	1420	1490	1520	1545	1540	1575	1615
1600	1620	1700	1720	1770	1760	1795	1830
1800	1820	1900	1930	1970	1960	2000	
2000	2020	2100	2135	2180	2165	2230	
2200	2220	2305	2345	2380	2375		
2400	2420	2505	2555	2590	2585		
2600	2620	2705	2760	2790	2785		
2800	2820	2920	2970	3010			
3000	3020	3120	3170	3225			
3200	3220	3320	3380				
3400	3420	3520	3590				
3600	3620	3730	3800				
3800	3820	3930					
4000	4020	4130					

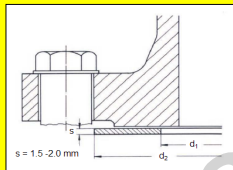

Note: other thicknesses on request

**gasket dimensions for tongue/groove flanges as per DIN 2691 (PN 10 - 160)**

DN	d1 [mm]	d2 [mm]
4-6	20	30
8	22	32
10	24	34
15	29	39
20	36	50
25	43	57
32	51	65
40	61	75
50	73	87
65	95	109
80	106	120
100	129	149
125	155	175
150	183	203
175	213	233
200	239	259
250	292	312
300	343	363
350	395	421
400	447	473
500	549	575
600	649	675
700	751	777
800	856	882
900	961	987
1000	1062	1092

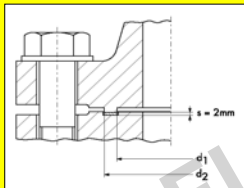

Note: other thicknesses on request

Jinan Hyupshin Flanges Co., Ltd

**gasket dimensions for male/female flanges as per DIN 2692 (PN 10 - 100)**

DN	d1 [mm]	d2 [mm]
10	18	34
15	22	39
20	28	50
25	35	57
32	43	65
40	49	75
50	61	87
65	77	109
80	90	120
100	115	149
125	141	175
150	169	203
175	195	233
200	220	259
250	274	312
300	325	363
350	368	421
400	420	473
500	520	575
600	620	675
700	720	777
800	820	882
900	920	987
1000	1020	1091

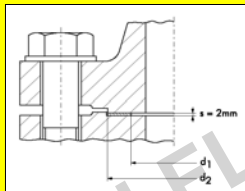

Note: other thicknesses on request

Jinan Hyupshin Flanges Co., Ltd

**gasket dimensions for full face flanges with bolt holes (FF) as per DIN 86071**

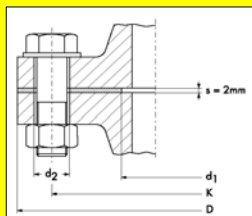

DN	d1 [mm]	PN 6				PN 10			
		D	K	d2 [mm]	Number of bolt holes	D	K	d2 [mm]	Number of bolt holes
20	29	90	65	11	4	105	75	14	4
25	36	100	75	11	4	115	85	14	4
32	47	120	90	14	4	140	100	18	4
40	53	130	100	14	4	150	110	18	4
50	65	140	110	14	4	165	125	18	4
65	81	160	130	14	4	185	145	18	4
80	93	190	150	18	4	200	160	18	8
100	120	210	170	18	4	220	180	18	8
125	146	240	200	18	8	250	210	18	8
150	172	265	225	18	8	285	240	22	8
175	200	295	255	18	8	315	270	22	8
200	225	320	280	18	8	340	295	22	8
250	282	375	335	18	12	395	350	22	12
300	332	440	395	22	12	445	400	22	12
350	363	490	445	22	12	505	460	22	16
400	415	540	495	22	16	565	515	26	16
450	467	595	550	22	16	615	565	26	20
500	520	645	600	22	20	670	620	26	20
600	620	755	705	26	20	780	725	30	20
700	723	860	810	26	24	895	840	30	24
800	825	975	920	30	24	1015	950	33	24
900	928					1115	1050	33	28
1000	1032					1230	1160	36	28
1200	1220					1455	1380	39	32
1400	1420					1675	1590	42	36
1600	1620					1915	1820	48	40
1800	1820					2115	2020	48	44
2000	2020					2325	2230	48	48

DN	d1 [mm]	PN 16				PN 25			
		D	K	d2 [mm]	Number of bolt holes	D	K	d2 [mm]	Number of bolt holes
20	29	105	75	14	4	105	75	14	4
25	36	115	85	14	4	115	85	14	4
32	47	140	100	18	4	140	100	18	4
40	53	150	110	18	4	150	110	18	4
50	65	165	125	18	4	165	125	18	4
65	81	185	145	18	4	185	145	18	8
80	93	200	160	18	8	200	160	18	8
100	120	220	180	18	8	235	190	22	8
125	146	250	210	18	8	270	220	26	8
150	172	285	240	22	8	300	250	26	8
175	200	315	270	22	8	330	280	26	12
200	225	340	295	22	12	360	310	26	12
250	282	405	355	26	12	425	370	30	12
300	332	460	410	26	12	485	430	30	16
350	363	520	470	26	16	555	490	33	16
400	415	580	525	30	16	620	550	36	16
450	467	640	585	30	20				
500	520	715	650	33	20	730	660	36	20
600	620	840	770	36	20	845	770	39	20
700	723	910	840	36	24	960	875	42	24
800	825	1025	950	39	24	1085	990	48	24
900	928	1125	1050	39	28	1185	1090	48	28
1000	1032	1255	1170	42	28	1320	1210	56	28

Note: other thicknesses on request

Jinan Hyupshin Flanges Co., Ltd

**gasket dimensions for full face flanges with bolt holes (FF) as per DIN 86072**

DN	d1 [mm]	D	K	d2 [mm]	Number of bolt holes
550	565	703	650	22	20
600	616	754	700	22	20
650	668	805	750	22	20
700	718	856	800	22	24
750	770	907	860	22	24
800	820	958	900	22	24
850	872	1010	950	22	28
900	922	1060	1010	22	28
950	972	1110	1060	22	28
1000	1024	1162	1110	22	32
1100	1128	1266	1210	22	32
1200	1228	1366	1310	22	36
1300	1328	1466	1410	22	40
1400	1428	1566	1510	22	40
1500	1528	1666	1610	22	44
1600	1628	1766	1710	22	48
1700	1728	1866	1810	22	48
1800	1828	1966	1910	22	52
1900	1928	2066	2010	22	56
2000	2028	2166	2110	22	56
2100	2128	2266	2210	22	60
2200	2228	2366	2310	22	64
2300	2328	2466	2410	22	64
2400	2428	2566	2510	22	68
2500	2528	2666	2610	22	72
2600	2628	2766	2710	22	72
2700	2728	2866	2810	22	76
2800	2828	2966	2910	22	80
2900	2928	3066	3010	22	80
3000	3028	3166	3110	22	84

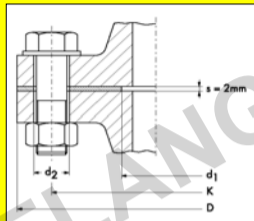

Note: other thicknesses on request

Jinan Hyupshin Flanges Co., Ltd