

HYUPSHIN FLANGES



Flanges

Flansche

Brides

SABS 1123 STEEL FLANGES – SOUTH AFRICA STANDARD

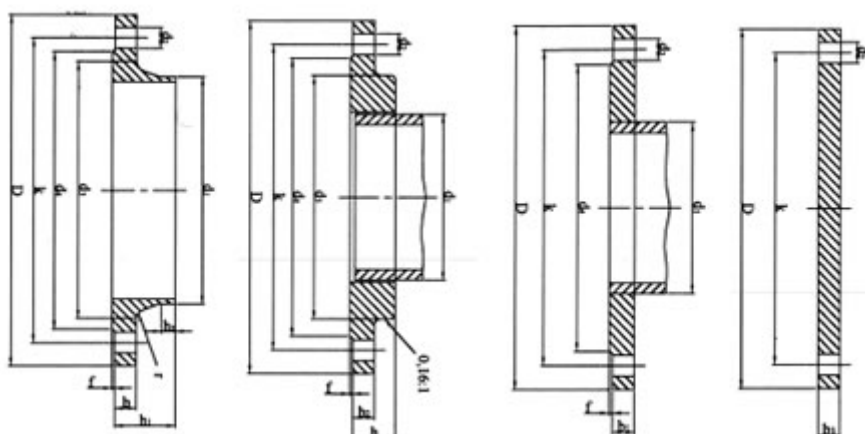

Nominal pressure 600 kPa 600/2 = Table 4 600/4 = Table 6 600/3 = Table 5 600/8 = Table 8																		
NB	Pipe	Flange							Raised Face		Bolt	Drilling			Neck		Boss	
	O.D.	D	b	b1	b2	b3	h	h1	d4	f		No.	d2	k	d3	h2	r	d5
	d1																	
10	17.2	75	8	10	8	10	16	28	35	2	M10	4	11	50	26	6	4	25
15	21.3	80	8	10	8	10	16	30	40	2	M10	4	11	55	30	6	4	30
20	26.9	90	8	10	8	10	18	32	50	2	M10	4	11	65	38	6	4	40
25	33.7	100	8	10	8	10	18	35	60	2	M10	4	11	75	42	6	4	50
32	42.4	120	8	10	8	10	20	35	70	2	M12	4	14	90	55	6	6	60
40	48.3	130	8	10	8	10	20	38	80	3	M12	4	14	100	62	7	6	70
50	60.3	140	8	10	8	10	22	38	90	3	M12	4	14	110	74	8	6	80
65	76.1	160	8	10	8	10	26	38	110	3	M12	4	14	130	88	9	6	100
80	88.9	190	10	10	10	10	28	42	128	3	M16	4	18	150	102	10	8	110
100	114.3	210	10	10	10	10	34	45	148	3	M16	4	18	170	130	10	8	130
*125	139.7	240	13	12	13	12	39	48	178	3	M16	8	18	200	155	10	8	160
150	168.3	265	13	12	13	12	39	48	202	3	M16	8	18	225	184	12	10	185
*175	193.7	295	13	14	-	14	-	52	230	3	M16	8	18	255	210	12	10	-
200	219.1	320	13	14	-	14	-	55	258	3	M16	8	18	280	236	15	10	-
*225	244.5	345	16	16	-	16	-	58	285	3	M16	8	18	305	264	15	12	-
250	273	375	16	16	-	16	-	60	312	3	M16	12	18	335	290	15	12	-
300	323.9	440	20	20	-	20	-	62	365	4	M20	12	22	395	342	15	12	-
350	355.6	490	22	22	-	22	-	62	415	4	M20	12	22	445	385	15	12	-
400	406.4	540	22	22	-	22	-	65	465	4	M20	16	22	495	438	15	12	-
450	457.2	595	24	25	-	25	-	65	520	4	M20	16	22	550	492	15	12	-
500	508	645	24	25	-	25	-	68	570	4	M20	20	22	600	538	15	12	-
550	559	705	24	28	-	28	-	68	620	5	M24	20	26	655	590	16	12	-
600	609.6	755	24	30	-	30	-	70	670	5	M24	20	26	705	640	16	12	-

* NP = Nominal Pressure 600kPa, 1000kPa, 1600kPa, 2500kPa, 4000kPa

SABS 1123 STEEL FLANGES – SOUTH AFRICA STANDARD

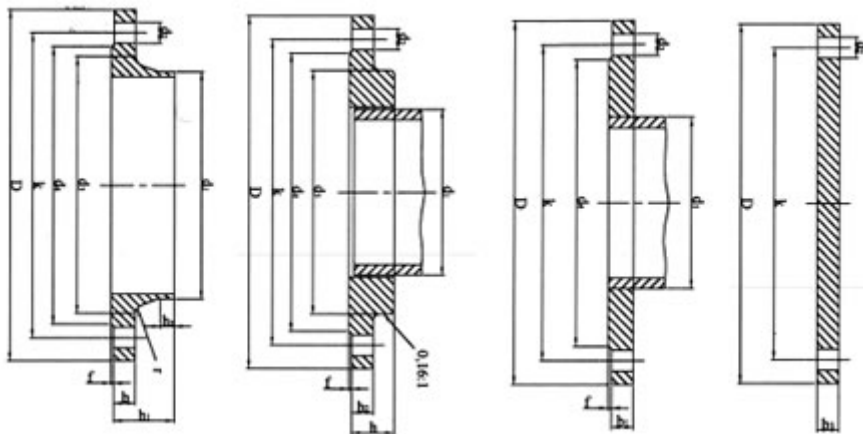

Nominal pressure 1000 kPa 1000/2 = Table 9 1000/4 = Table 11 1000/3 = Table 10 1000/8 = Table 13																		
NB	Pipe	Flange						Raised		Bolt	Drilling			Neck		Boss		
	d1	D	b	b1	b2	b3	h	h1	d4		f	No.	d2	k	d3	h2	r	d5
10	17.2	90	8	10	8	10	14	35	40	2	M12	4	14	60	28	6	4	30
15	21.3	95	8	10	8	10	14	35	45	2	M12	4	14	65	32	6	4	35
20	26.9	105	8	10	8	10	16	38	58	2	M12	4	14	75	40	6	4	45
25	33.7	115	8	10	8	10	16	38	68	2	M12	4	14	85	46	6	4	52
32	42.4	140	10	10	10	10	20	40	78	2	M16	4	18	100	56	6	6	60
40	48.3	150	10	10	10	10	20	42	88	3	M16	4	18	110	64	7	6	70
50	60.3	165	12	10	10	12	20	45	102	3	M16	4	18	125	75	8	6	85
65	76.1	185	12	12	12	12	26	45	122	3	M16	4	18	145	90	10	6	105
80	88.9	200	14	12	12	14	26	50	138	3	M16	8	18	160	105	10	8	118
100	114.3	220	14	12	12	14	32	52	158	3	M16	8	18	180	131	12	8	140
*125	139.7	250	16	14	14	16	36	55	188	3	M16	8	18	210	156	12	8	168
150	168.3	285	18	16	16	18	38	55	212	3	M20	8	22	240	184	12	10	195
*175	193.7	315	18	16	-	18	-	60	242	3	M20	8	22	270	210	12	10	-
200	219.1	340	18	18	-	18	-	62	268	3	M20	8	22	295	235	16	10	-
*225	244.5	370	18	18	-	18	-	62	290	3	M20	8	22	325	265	16	10	-
250	273.0	395	20	20	-	20	-	68	320	3	M20	12	22	350	292	16	12	-
300	323.9	445	22	22	-	22	-	68	370	4	M20	12	22	400	344	16	12	-
350	355.6	505	26	25	-	25	-	68	430	4	M20	16	22	460	385	16	12	-
400	406.4	565	26	25	-	25	-	72	482	4	M24	16	26	515	400	16	12	-
450	457.2	615	28	30	-	30	-	72	532	4	M24	20	26	565	492	16	12	-
500	508.0	670	28	32	-	32	-	75	585	4	M24	20	26	620	542	16	12	-
550	559.0	730	28	35	-	35	-	80	635	5	M24	20	26	675	592	18	12	-
600	609.6	780	28	38	-	38	-	80	685	5	M24	20	26	725	642	18	12	-

* NP = Nominal Pressure 600kPa, 1000kPa, 1600kPa, 2500kPa, 4000kPa

SABS 1123 STEEL FLANGES – SOUTH AFRICA STANDARD

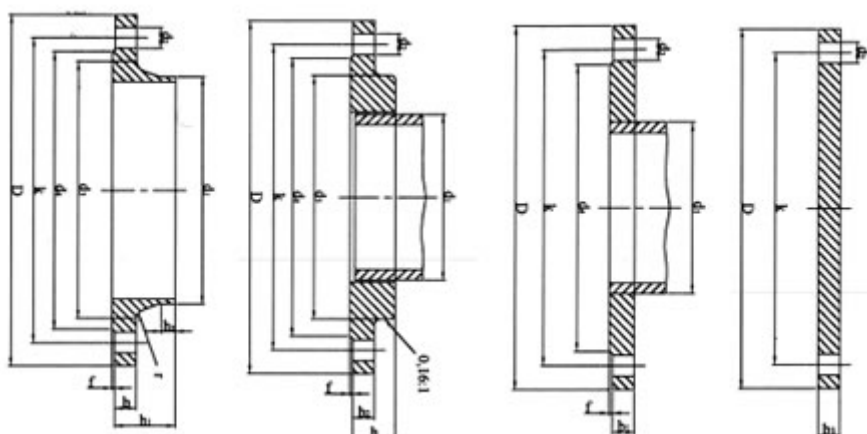

Nominal pressure 1600 kPa 1600/2 = Table 14 1600/4 = Table 16 1600/3 = Table 15 1600/8 = Table 18																		
NB	Pipe	Flange									Raised	Bolt	Drilling			Neck		Boss
	d1	D	b	b1	b2	b3	h	h1	d4	f	No.		d2	k	d3	h2	r	d5
10	17.2	90	8	10	8	10	14	35	40	2	M12	4	14	60	28	6	4	30
15	21.3	95	8	10	8	10	14	35	45	2	M12	4	14	65	32	6	4	35
20	26.9	105	8	10	8	10	16	38	58	2	M12	4	14	75	40	6	4	45
25	33.7	115	8	10	8	10	16	38	68	2	M12	4	14	85	46	6	4	52
32	42.4	140	10	10	10	10	20	40	78	2	M16	4	18	100	56	6	6	60
40	48.3	150	10	10	10	10	20	42	88	3	M16	4	18	110	64	7	6	70
50	60.3	165	12	12	12	12	22	45	102	3	M16	4	18	125	75	8	6	85
65	76.1	185	12	12	12	12	26	45	122	3	M16	4	18	145	90	10	6	105
80	88.9	200	14	14	14	14	28	50	138	3	M16	8	18	160	105	10	8	118
100	114.3	220	14	14	14	14	34	52	158	3	M16	8	18	180	131	12	8	140
*125	139.7	250	16	16	16	16	38	55	188	3	M16	8	18	210	156	12	8	168
150	168.3	285	18	18	18	18	40	55	212	3	M20	8	22	240	184	12	10	195
*175	193.7	315	20	20	-	20	-	60	242	3	M20	8	22	270	210	12	10	-
200	219.1	340	22	22	-	22	-	62	268	3	M20	12	22	295	235	16	10	-
*225	244.5	370	24	22	-	22	-	66	294	3	M20	12	22	325	265	16	10	-
250	273.0	405	24	25	-	25	-	70	320	3	M24	12	26	355	292	16	12	-
300	323.9	460	28	28	-	28	-	78	378	4	M24	12	26	410	344	16	12	-
350	355.6	520	30	30	-	30	-	82	438	4	M24	16	26	470	390	16	12	-
400	406.4	580	32	35	-	35	-	85	490	4	M24	16	26	525	445	16	12	-
450	457.2	640	34	40	-	40	-	87	550	4	M24	20	26	585	496	16	12	-
500	508.0	715	34	40	-	40	-	90	610	4	M30	20	33	650	548	16	12	-
550	559.0	775	36	-	-	-	-	95	670	5	M30	20	33	710	600	18	12	-
600	609.6	840	36	50	-	-	-	95	725	5	M30	20	33	770	652	18	12	-

* NP = Nominal Pressure 600kPa, 1000kPa, 1600kPa, 2500kPa, 4000kPa

SABS 1123 STEEL FLANGES – SOUTH AFRICA STANDARD

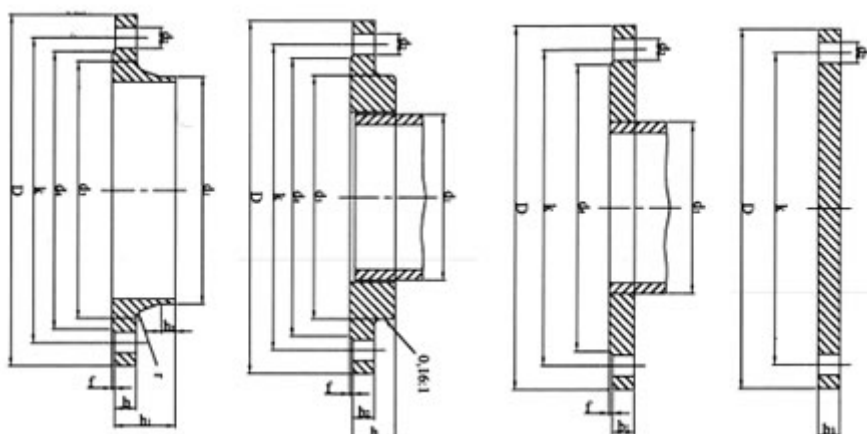

Nominal pressure 2500 kPa 2500/2 = Table 19 2500/4 = Table 21 2500/3 = Table 20 2500/8 = Table 23																		
NB	Pipe	Flange							Raised		Bolt	Drilling			Neck		Boss	
	d1	D	b	b1	b2	b3	h	h1	d4	f		No.	d2	k	d3	h2	r	d5
10	17.2	90	12	12	10	12	16	35	40	2	M12	4	14	60	28	6	4	30
15	21.3	95	14	14	11	14	17	38	45	2	M12	4	14	65	32	6	4	35
20	26.9	105	14	14	11	14	19	40	58	2	M12	4	14	75	40	6	4	45
25	33.7	115	16	16	12	16	22	40	68	2	M12	4	14	85	46	6	4	52
32	42.4	140	18	18	14	18	26	42	78	2	M16	4	18	100	55	6	6	60
40	48.3	150	18	20	14	20	28	45	88	3	M16	4	18	110	64	7	6	70
50	60.3	165	20	20	17	20	31	48	102	3	M16	4	18	125	75	8	6	85
65	76.1	185	22	22	17	22	33	52	122	3	M16	8	18	145	90	10	6	105
80	88.9	200	24	22	18	22	34	58	138	3	M16	8	18	160	105	12	8	118
100	114.3	235	24	25	21	25	41	65	162	3	M20	8	22	190	134	12	8	145
*125	139.7	270	26	28	24	28	46	68	188	3	M24	8	26	220	162	12	8	170
150	168.3	300	28	30	24	30	48	75	218	3	M24	8	26	250	192	12	10	200
*175	193.7	330	30	30	-	25	-	75	248	3	M24	12	26	280	218	15	10	-
200	219.1	360	30	30	-	30	-	80	278	3	M24	12	26	310	244	16	10	-
*225	244.5	395	30	30	-	30	-	84	306	3	M24	12	26	340	270	16	10	-
250	273.0	425	30	30	-	30	-	88	335	3	M24	12	26	370	298	18	12	-
300	323.9	485	34	32	-	32	-	92	395	4	M24	16	26	430	352	18	12	-
350	355.6	555	38	35	-	35	-	100	450	4	M30	16	33	490	398	20	12	-
400	406.5	620	40	40	-	40	-	110	505	4	M30	16	33	550	452	20	12	-
450	457.2	670	42	45	-	45	-	110	555	4	M30	20	33	600	505	20	12	-
500	508.0	730	44	50	-	50	-	125	615	4	M30	20	33	660	558	20	12	-
550	559.0	785	-	55	-	-	-	-	670	5	M36	20	39	710	-	-	-	-
600	609.6	845	46	60	-	-	-	125	720	5	M36	20	39	770	660	20	12	-

* NP = Nominal Pressure 600kPa, 1000kPa, 1600kPa, 2500kPa, 4000kPa

SABS 1123 STEEL FLANGES – SOUTH AFRICA STANDARD

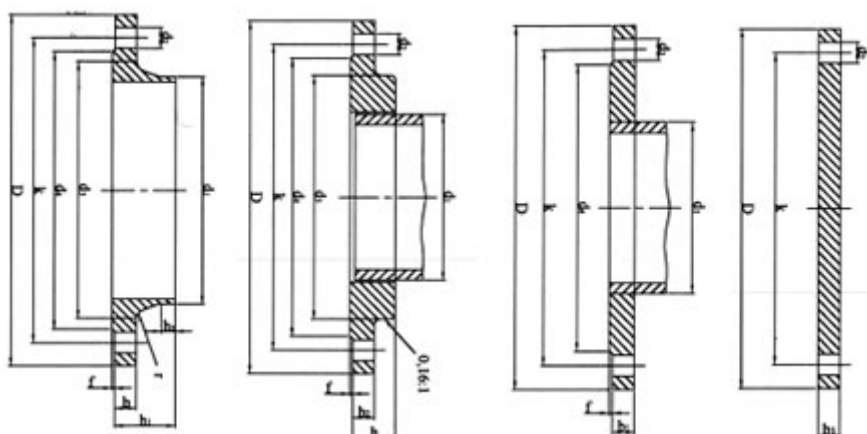

Nominal pressure 4000 kPa 4000/2 = Table 24 4000/4 = Table 26 4000/3 = Table 25 4000/8 = Table 28																		
NB	Pipe	Flange							Raised		Bolt	Drilling			Neck		Boss	
	d1	D	b	b1	b2	b3	h	h1	d4	f		No.	d2	k	d3	h2	r	d5
10	17.2	90	12	12	12	12	18	35	40	2	M12	4	14	60	28	6	4	30
15	21.3	95	14	14	14	14	20	38	45	2	M12	4	14	65	32	6	4	35
20	26.9	105	14	14	14	14	22	40	58	2	M12	4	14	75	40	6	4	45
25	33.7	115	16	16	16	16	26	40	68	2	M12	4	14	85	46	6	4	52
32	42.4	140	18	18	18	18	30	42	78	2	M16	4	18	100	55	6	6	60
40	48.3	150	18	20	18	20	32	45	88	3	M16	4	18	110	64	7	6	70
50	60.3	165	20	20	20	20	34	48	102	3	M16	4	18	125	75	8	6	85
65	76.1	185	22	22	22	22	38	52	122	3	M16	8	18	145	90	10	6	105
80	88.9	200	24	22	24	22	40	58	138	3	M16	8	18	160	105	12	8	118
100	114.3	235	24	25	24	25	44	65	162	3	M20	8	22	190	134	12	8	145
*125	139.7	270	26	28	26	28	48	68	188	3	M24	8	26	220	162	12	8	170
150	168.3	300	28	30	28	30	52	75	218	3	M24	8	26	250	192	12	10	200
*175	193.7	350	32	32	-	32	-	82	260	3	M24	12	26	295	218	15	10	-
200	219.1	375	34	32	-	32	-	88	285	3	M24	12	26	320	244	16	10	-
*225	244.5	420	36	35	-	35	-	100	315	3	M30	12	33	355	275	18	12	-
250	273.0	450	38	38	-	38	-	105	345	3	M30	12	33	385	306	18	12	-
300	323.9	515	42	40	-	40	-	115	410	4	M30	16	33	450	362	18	12	-
350	355.6	580	46	45	-	45	-	125	465	4	M30	16	33	510	408	20	12	-
400	406.4	660	50	50	-	50	-	135	535	4	M36	16	39	585	462	20	12	-
450	457.2	685	52	60	-	60	-	140	575	4	M36	20	39	610	510	20	12	-
500	508.0	755	52	70	-	70	-	140	615	4	M36	20	39	670	562	20	12	-
550	-	-	-	-	-	-	-	-	-	-	-	-	-	-	-	-	-	-
600	-	-	-	-	-	-	-	-	-	-	-	-	-	-	-	-	-	-

* NP = Nominal Pressure 600kPa, 1000kPa, 1600kPa, 2500kPa, 4000kPa

We Supply following steel flanges in norms:

In BS 10-Standard:

BS 10 TABLE D

BS 10 TABLE E

BS 10 TABLE F

In BS 4504-Standard:

Blind Flanges 6/8, 10/8, 16/8, 25/8, 40/8

Plate Flanges 6/3, 10/3, 16/3, 25/3, 40/3

Slip On Flanges 6/5, 10/5, 16/5, 25/5, 40/5

Threaded Flanges 6/4, 10/4, 16/4, 25/4, 40/4

In SABS 1123 Standard:

Blind Flanges 600/8, 1000/8, 1600/8, 2500/8, 4000/8

Plate Flanges 600/3, 1000/3, 1600/3, 2500/3, 4000/3

Slip On Flanges 600/5, 1000/5, 1600/5, 2500/5, 4000/5

Threaded Flanges 600/4, 1000/4, 1600/4, 2500/4, 4000/4

Raw Material for Carbon Steel:

Carbon Steel A105, A350 etc

We provide all flanges according to your specifications and drawings, we delivery flanges to all ports where you in anywhere.

JINAN HYUPSHIN FLANGES CO., LTD

No6, Nanbei Road, Niupai,Mingshui,
Zhangqiu City, Shandong,
China - 250 200

President : Mr. Guo Zhaoji

Director : Mr. Hong Songjo

Tel : + 86 531 832 945 52

Fax : + 86 531 832 918 78

Sales Manager: Mr. Austin. Guo

Tel : + 86 531 832 977 28

Fax : + 86 531 832 918 78

Email: austin@hyupshin.cn

Skype : iguorui

For Flanges sales & enquiries:

sale@hyupshin.cn

www.hsflange.com

www.hyupshin.cn