

Dimensions of PN 160 – PN 400 Flanges DIN EN 1092-1

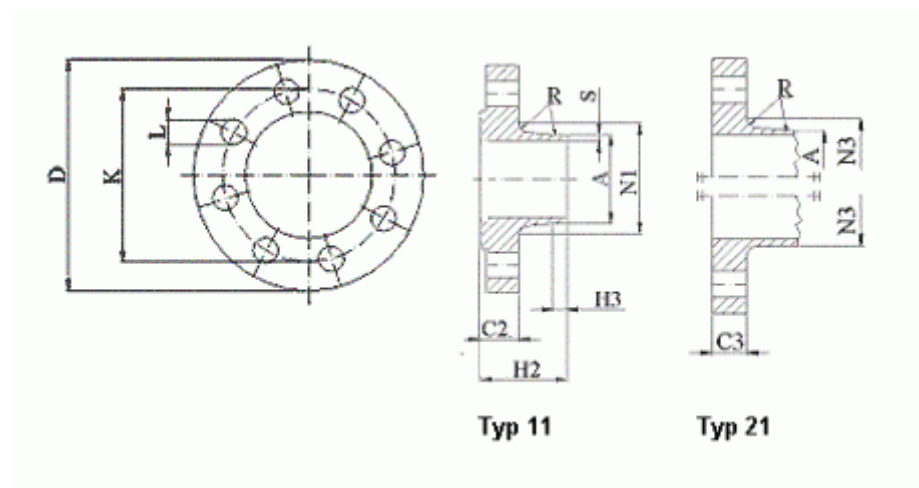

HYUPSHIN FLANGES

Dimensions in mm

DIN EN 1092-1 PN-160 Flange

Nominal diameter	Mating dimensions						Outside diameter of neck	Flange Thickness			Length		Neck Diameters		Corner radius	Neck thickness (preferred values)	
	Outside diameter	Diameter of bolt circle	Diameter of bolt hole	Boltting		A		C2	C3	H2	H3	N1	N3	R1			S
	D	K	L	No.	Size												
DN	11, 21						11 21*	11	21	11	11	11	21	11	21	11	
10	100	70	14	4	M12	17.2	20	20	45	6	32	40	4	4	2		
15	105	75	14	4	M12	21.3	20	20	45	6	34	45	4	4	2		
25	140	100	18	4	M16	33.7	24	24	58	8	52	61	4	4	2.9		
40	170	125	22	4	M20	48.3	28	28	64	10	70	82	6	4	3.6		
50	195	145	26	4	M24	60.3	30	30	75	10	90	96	6	4	4		
65	220	170	26	8	M24	76.1	34	34	82	12	108	118	6	5	5		
80	230	180	26	8	M24	88.9	36	36	86	12	120	128	8	5	6.3		
100	265	210	30	8	M27	114.3	40	40	100	12	150	150	8	5	8		
125	315	250	33	8	M30	139.7	44	44	115	14	180	184	8	6	10		
150	355	290	33	12	M30	168.3	50	50	128	14	210	224	10	6	12.5		
200	430	360	36	12	M33	219.1	60	60	140	16	278	288	10	8	16		
250	515	430	42	12	M39	273	68	68	155	18	340	346	12	8	20		
300	585	500	42	16	M39	323.9	78	78	175	18	400	414	12	10	22.2		

* For flanges type 21 the outside hub diameter approximately corresponds to the outside pipe diameter.

DIN EN 1092-1 PN-250 Flange

Nominal diameter	Mating dimensions						Outside diameter of neck	Flange Thickness			Length		Neck Diameters		Corner radius	Neck thickness (preferred values)	
	Outside diameter	Diameter of bolt circle	Diameter of bolt hole	Boltting		A		C2	C3	H2	H3	N1	N3	R1			S
	D	K	L	No.	Size												
DN	11, 21						11 21*	11	21	11	11	11	21	11	21	11	
10	125	85	18	4	M16	-	-	24	-	-	-	46	-	4	-		
15	130	90	18	4	M16	21.3	26	26	60	6	48	52	4	4	2.6		
25	150	105	22	4	M20	33.7	28	28	65	8	60	63	4	4	3.6		
40	185	135	26	4	M24	48.3	34	34	80	10	80	90	6	4	5		
50	200	150	26	4	M24	60.3	38	38	85	10	84	102	6	5	6.3		
65	230	180	26	8	M24	76.1	42	42	95	12	95	125	6	5	8		
80	255	200	30	8	M27	101.6	46	46	102	12	136	142	8	5	11		
100	300	235	33	8	M30	127	54	54	120	14	164	168	8	6	14.2		
125	340	275	33	8	M30	152.4	60	60	140	16	200	207	8	6	16		
150	390	320	36	12	M33	177.8	68	68	160	18	240	246	10	8	17.5		
200	485	400	42	12	M39	244.5	82	82	190	25	305	314	10	8	25		
250	585	490	48	16	M45	298.5	100	100	215	30	385	394	12	10	32		
300	690	590	52	16	M48	-	-	120	-	-	-	480	-	10	-		

* For flanges type 21 the outside hub diameter approximately corresponds to the outside pipe diameter.

* For flanges type 11 use flanges PN 320

DIN EN 1092-1 PN-320 Flange

Nominal diameter	Mating dimensions						Outside diameter of neck	Flange Thickness			Length		Neck Diameters		Corner radius	Neck thickness (preferred values)	
	Outside diameter	Diameter of bolt circle	Diameter of bolt hole	Boltting		A		C2	C3	H2	H3	N1	N3	R1			S
	D	K	L	No.	Size												
DN	11, 21						11 21*	11	21	11	11	11	21	11	21	11	
10	125	85	18	4	M16	17.2	24	24	58	-	44	46	4	4	2.6		
15	130	90	18	4	M16	21.3	26	26	60	6	48	52	4	4	3.2		
25	160	115	22	4	M20	33.7	34	34	78	8	68	72	4	5	5		
40	195	145	26	4	M24	48.3	38	38	88	10	92	96	6	5	6.3		
50	210	160	26	8	M24	63.5	42	42	100	10	106	110	6	6	8		
65	255	200	30	8	M24	88.9	51	51	120	12	138	137	6	6	11		
80	275	220	30	8	M27	101.6	55	55	130	14	156	160	8	5	12.5		
100	335	265	36	8	M33	133	65	65	145	16	186	190	8	8	16		
125	380	310	36	12	M33	168.3	75	75	175	20	230	235	8	8	20		
150	425	350	39	12	M36	193.7	84	84	195	25	265	266	10	10	25		
200	525	440	42	16	M39	244.5	103	103	235	30	345	350	10	10	30		
250	640	540	52	16	M48	323.9	125	125	300	40	428	432	12	10	40		

* For flanges type 21 the outside hub diameter approximately corresponds to the outside pipe diameter.

DIN EN 1092-1 PN-400 Flange

Nominal diameter	Mating dimensions						Outside diameter of neck	Flange Thickness			Length		Neck Diameters		Corner radius	Neck thickness (preferred values)	
	Outside diameter	Diameter of bolt circle	Diameter of bolt hole	Boltting		A		C2	C3	H2	H3	N1	N3	R1			S
	D	K	L	No.	Size												
DN	11, 21						11 21*	11	21	11	11	11	21	11	21	11	
10	125	85	18	4	M16	17.2	28	28	65	8	48	48	4	4	3.6		
15	145	100	22	4	M20	26.9	30	30	68	8	56	57	4	4	5		
25	180	130	26	4	M24	42.4	38	38	90	10	82	81	4	5	7.1		
40	220	165	30	4	M27	60.3	48	48	110	12	106	105	6	5	10		
50	235	180	30	8	M27	76.1	52	52	120	15	120	120	6	6	12.5		
65	290	225	33	8	M30	101.6	64	64	135	18	158	158	6	6	16		
80	305	240	33	8	M30	114.3	68	68	150	20	174	174	8	8	17.5		
100	370	295	39	8	M36	139.7	80	80	175	25	216	216	8	8	22.2		
125	415	340	39	12	M36	193.7	92	92	200	30	258	259	8	10	30		
150	475	390	42	12	M39	219.1	105	105	225	35	302	302	10	10	35		
200	585	490	48	16	M45	273	130	130	280	40	388	388	10	10	40		

* For flanges type 21 the outside hub diameter approximately corresponds to the outside pipe diameter.

D: Outside Diameter
K: Diameter of Bolt Circle
L: Diameter of Bolt Hole
A: Outside Diameter of Neck
F: Collar thickness
G max: Diameter of Shoulders
N: Neck Diameter
E: Chamfer
R: Corner Radius
S: Neck Thickness (Preferred value)

* For flanges type 21 the outside hub diameter approximately corresponds to the outside pipe diameter,

NOTE: The p/t ratings from EN 1092-1 apply only for flange types 05, 11, 12, 13 and 21 having nominal sizes up to and including DN 600. The p/t rating of all other flanges shall be agreed between the manufacturer and the purchaser.

HYUPSHIN FLANGES